

KUNUNURRA PICTURE GARDENS
Coolibah Drive, Kununurra

Prepared by Alan Surgener
Consultant to **Measure Up! 2006**
Country Arts WA

Shire of Wyndham East Kimberley
Kununurra Office Tel: 08 9168 4100
Web: www.thelastfrontier.com.au



GENERAL DESCRIPTION

Unique to WA! This 1 metre high outdoor stage in a tin shed case is bang in the middle of town and shares a massive 15,000 square metre block with the local outdoor cinema. There is a concrete pad in front of the stage seating an intimate 300, or you could throw caution to the wind and let in 5000.

The whole front wall of the shed is hinged and opens up to reveal a 12000mm wide x 6000mm deep stage with a newly laid timber dance floor and two dressing rooms backstage. There is a 32 amp three phase outlet upstage centre, and FOH lighting bar 1800mm in front.



Side elevation showing doorpost and ramp

TOURING TIPS

- The 2750 high back wall crossover has a mirror on it, so you'll need to cover it over.
- No toilets backstage, so use the public toilets in the cinema projection building located in the same grounds.
- Keep your PA stacks outside and avoid loud fold back inside, some groups say the tin interior acts like a rattling drum. Leave plenty of time in your schedule for sound checks.
- The Kununurra Leisure Centre has loose plastic chairs which may be available to borrow or hire if seating is required.

DIMENSIONS – All dimensions in mm

Stage depth	6000
Stage width	12100
Stage height	1000
Stage thrust	0
Stage floor to ceiling	4140
Stage floor to lx bars	3220
Proscenium width	12100
Proscenium height	3200
Auditorium depth	17000* concrete pad FOH
Auditorium width	12000* concrete pad FOH
Aud floor to ceiling	N/a
Aud floor to lx bars	N/a

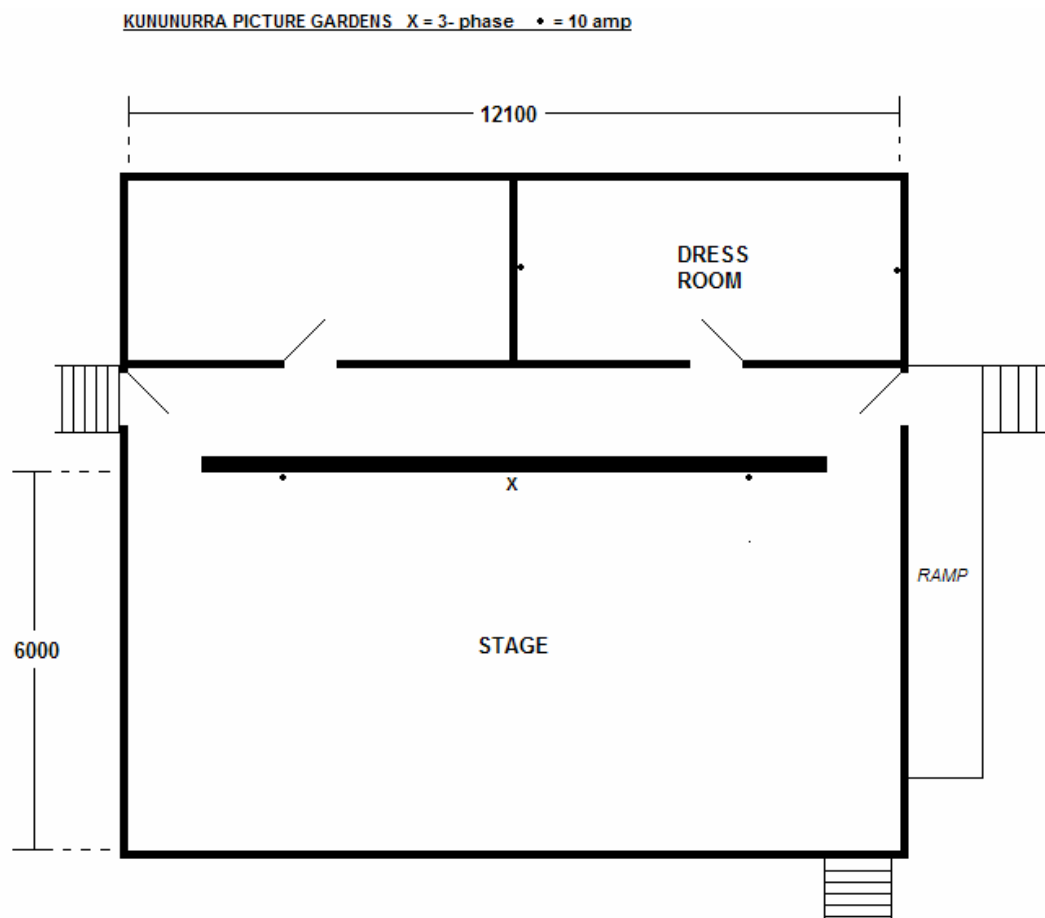

FLYING FACILITIES

Flying system	N
Masking	Fixed 2750 high crossover wall With a black cotton leg masking each side entrance
Cyclorama	N

SIDE ELEVATION

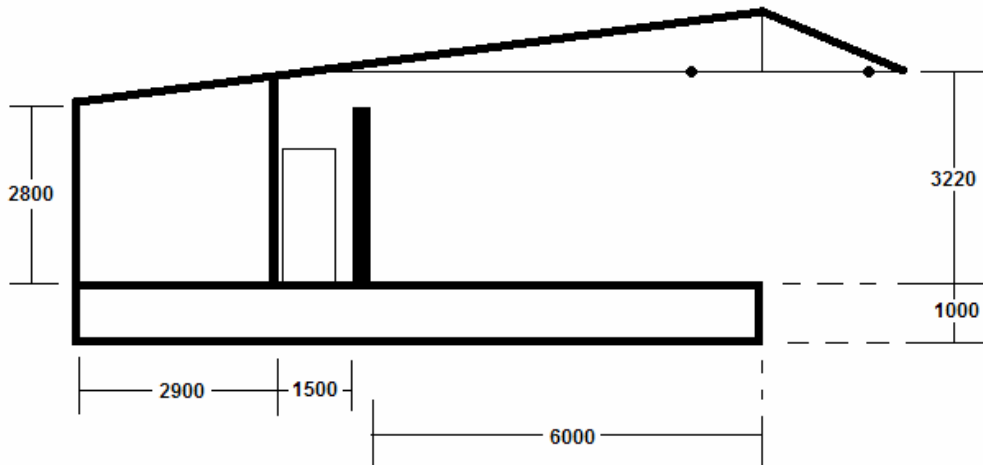

LIGHTING FACILITIES

3 phase power and location	1 x 32 amp front centre of upstage crossover wall
Operating location (s)	N
Lighting desk	N
Dimmers and location	N
Wired lighting bars number of circuits and locations	N
Patching facilities	N
Lamp stock	N
Alternative onstage lighting positions	Full length scaffold bar 1100 up from edge of stage 3 x scaffold bars running up to down stage centre/left/right (see plan)
Alternative front lighting positions	1 x full length FOH bar 1800 out from edge of stage
Type of ceiling/ Possible fixing points	Exposed 50mm square roof truss supporting a tin roof
Blackout	N
Ladders	Small A frame for onstage, nothing for FOH
Onstage 10amp outlets	2 x doubles USL 2 x doubles USR
Foh 10amp outlets	N
Houselights	N
Working lights	3 onstage flouros 1 x floodlight on FOH bar centre

LX BAR POSITIONS

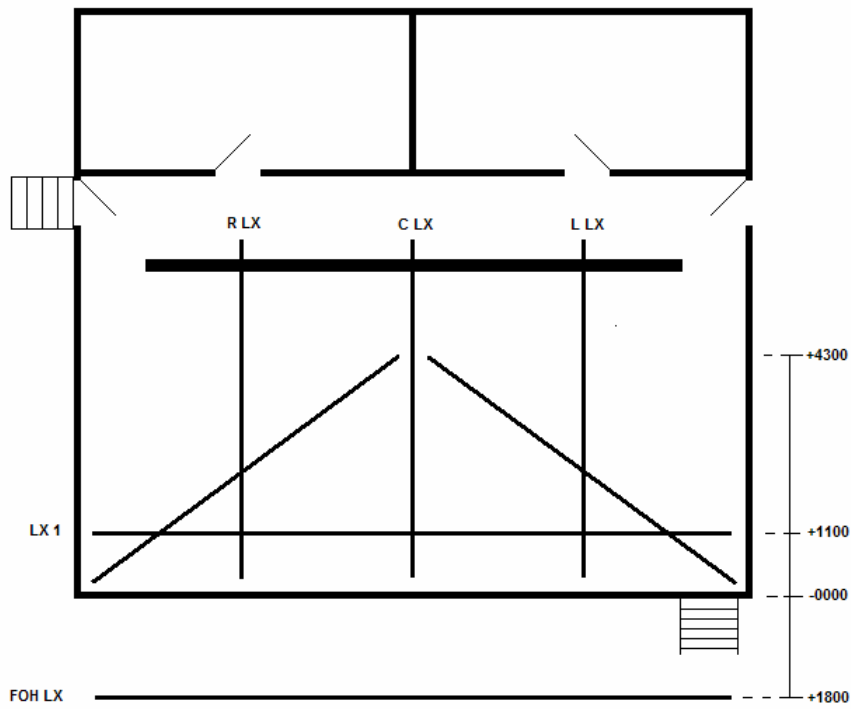

SOUND FACILITIES

Operating position (s)	N
Sound desk	N
Amplifiers	N
Speakers	N
Foldback	N
Microphones	N
Mic stands	N
Cd or cassette players	N
Sends	N



Stage right interior photo. Note upstage crossover wall with mirror, and diagonal scaffold bars in grid.

COMMUNICATIONS

Talk-back	N
Telephones	N
Internet	N

ONSTAGE FACILITIES

Crossover	Yes
Wing space	None
Treads to foh	One, very old, fixed 5 step DSL
Ladder	N
Rostra	N
Blue worklight	N

FRONT OF HOUSE FACILITIES (FOH) Relates to audience and front staff

Seating	Some old canvas chairs used by cinema
Box office	At front gate
Bar	N
Kitchen	N
Toilets	Y - located at projection house 50m away
Air conditioning	N
Heating	!

BACKSTAGE FACILITIES

Green room	N
Dressing rooms	Y - 1 dressing room backstage with sinks, mirrors and ceiling fans
Toilets	N
Showers	N
Mirrors	Y
Laundry	N
Ironing	N

BUMP-IN ACCESS

Access description	Load directly onto stage front
Loading door size	There is one 800 wide door USL which has a 1200 wide ramp leading up to it
Exterior lighting	N
Parking	Masses outside the grounds
Storage	Nothing inside the grounds

EMERGENCY SYSTEMS

Smoke alarms	N
Sprinkler systems	N
Fire extinguishers	One each side of stage
Fire hoses	N
Emergency exits	N
Exit signs	N
Medical contact	

PRE-SALES

Ticketing system	
Advertising positions	
Posters/banners	
Local publications	
Local radio	
Word of mouth	

FRIENDLY NEIGHBOURS

Doctor	
Hardware	
Publican	
Newsagent	
People to inform	